



VERTICAL MACHINING CENTER

VMC-2150 / 2600 / 3200

CNC-TAKANG

CNC-TAKANG CO., LTD.
MANUFACTURER & EXPORTER

VMC-2150

VMC-2150

- 2150mm (85") / 1100mm (43") / 900mm (35") Travel
- 18.5kw ~ 26kw High torque spindle
- 24 Tools arm type ATC
- 21000 kgs



VMC-2150

COLUMN

The oversized box type

Column:

908mm (36")D x 1100mm (43")W x 2450mm (96")H

The best support at spindle head heavy cutting and column stiffness.

SADDLE

4 meters length super heavy saddle, guaranteed no table overhang for table movement.

TABLE

Standard 2200mm (87") x 1220mm (48")

Extra wide working table Handles big heavy workpiece.



Spindle head is internally wrapped by column slideways to give much more rigidity & stiffness than competitors' traditional design.



Extra wide interior space

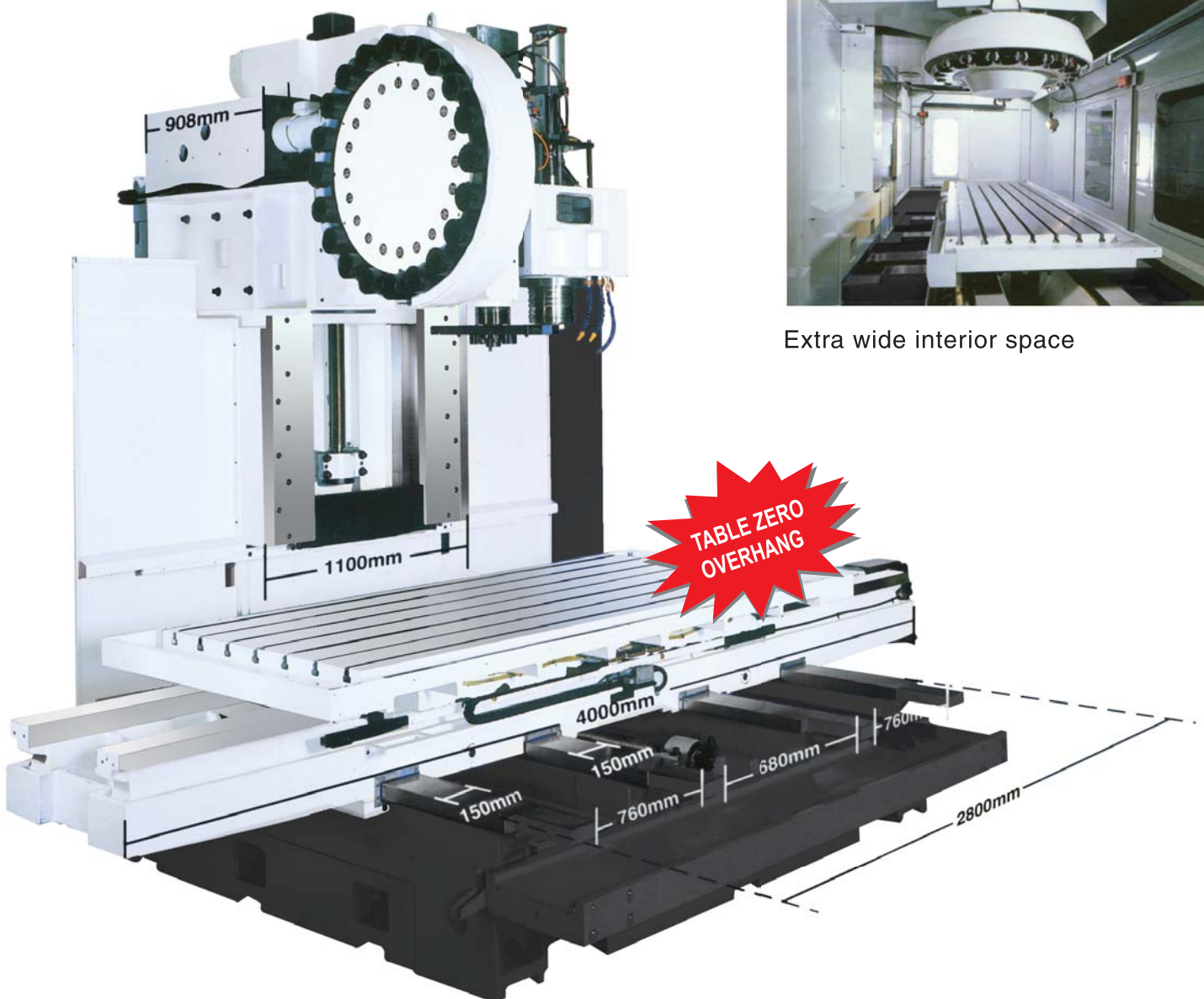

- 2600mm (102") / 1100mm (43") / 900mm (35") Travel
- 18.5kw ~ 26kw High torque spindle
- 24 Tools arm type ATC
- 22000 kgs

▶ Table splash guard (OPT)

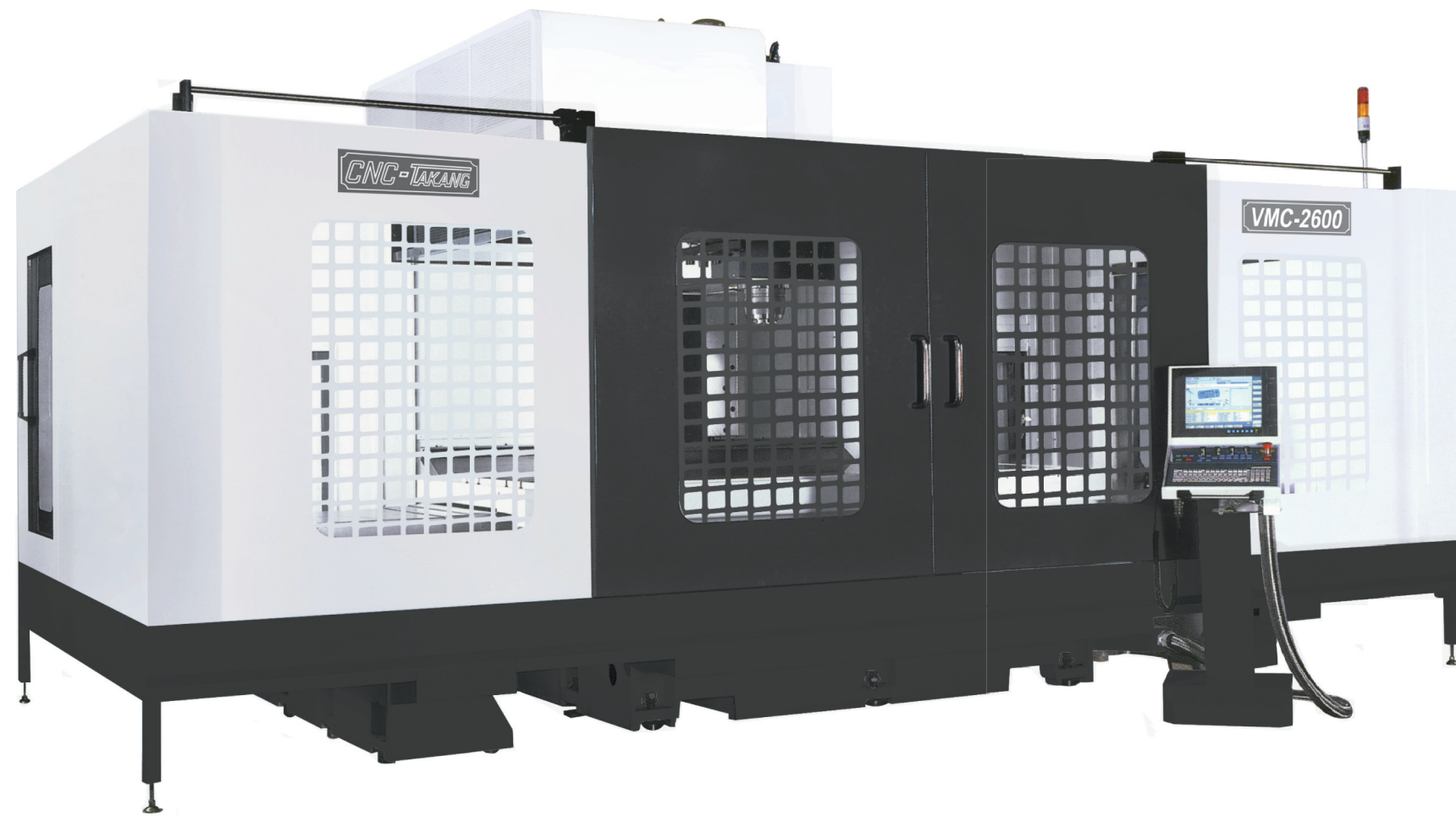

VMC-2600



COLUMN:
The oversized box type
Column 908mm (36")D x 1100mm (43")W x 2450mm (96")H
The best support at spindle head heavy cutting and column stiffness.

TABLE:
Standard
2650mm (104") x 1220mm (48") Extra wide working table
Handles big heavy workpiece.

SADDLE:
4.9 Meters length super heavy saddle, guaranteed no table overhang for table movement.

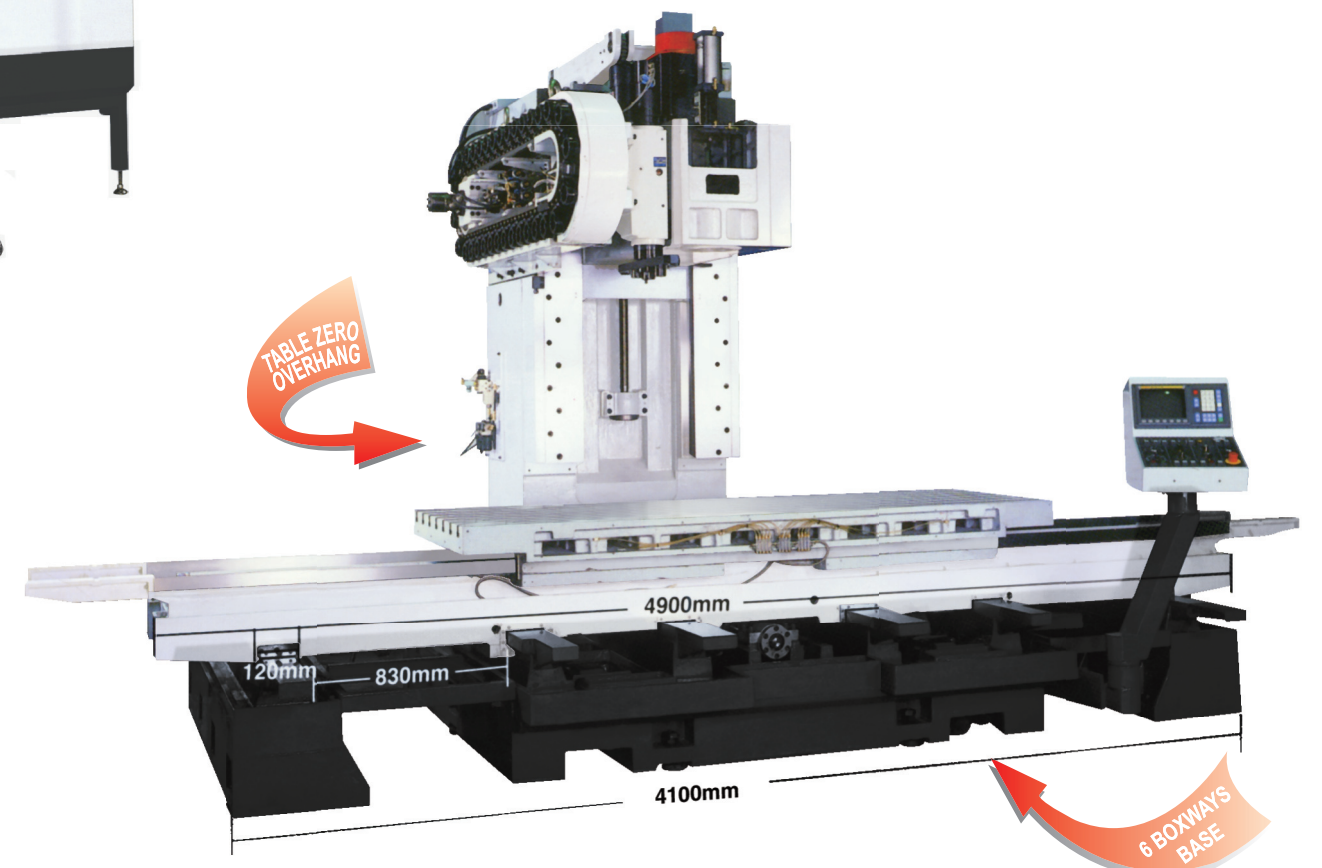

- 3200mm (126") / 1100mm (43") / 900mm (35") Travel
- 18.5kw~26kw High torque spindle
- 24 Tools arm type ATC
- 24000 kgs

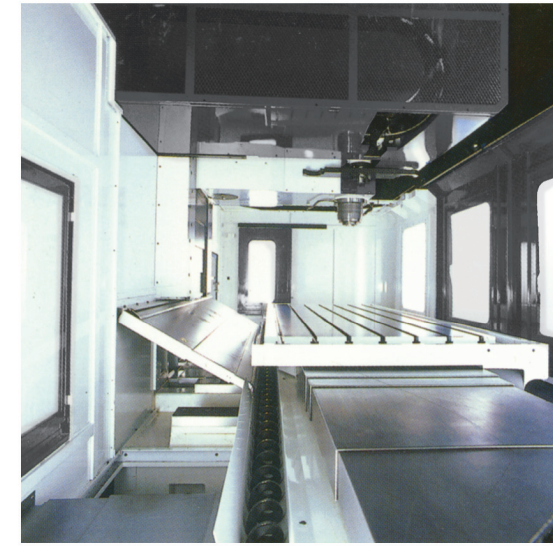

Extra wide interior space

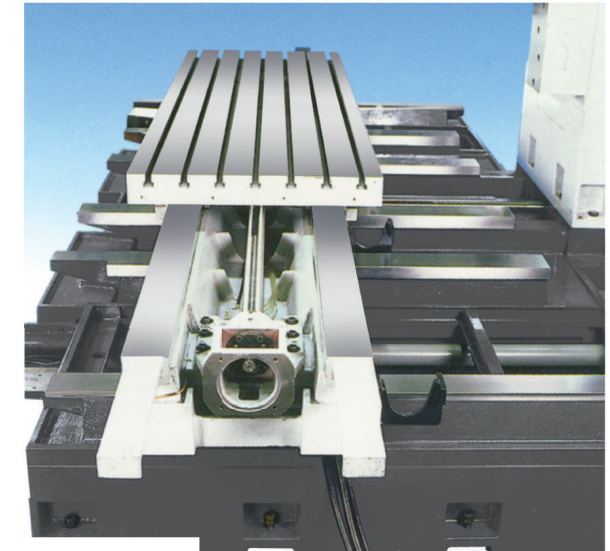

6 Boxways base



VMC-3200

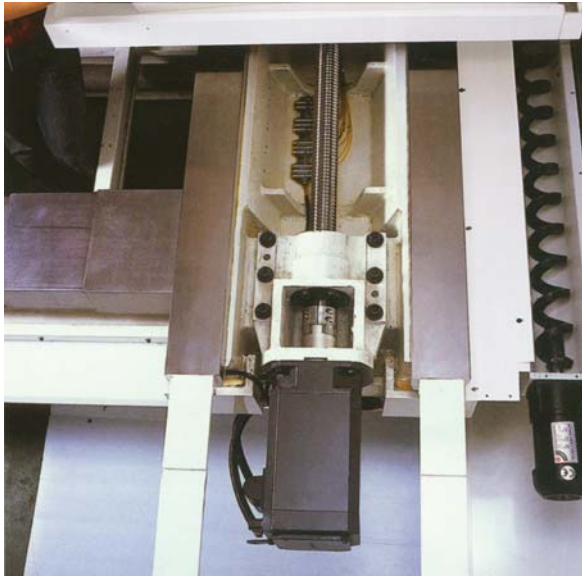

Directly coupled between ballscrew and servo motor

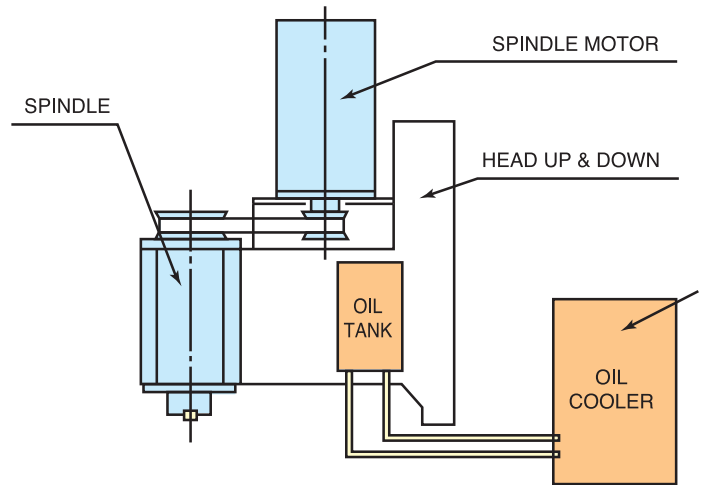

Built-in head oil tank to reduce heat displacement from : Spindle rotation, spindle motor rotation and head's up & down movements, always maintain the best thermal controlled accuracy on Z axis.(opt)

Guaranteed Machine Accuracy

Accuracy \ Standard	JIS Required	Our guaranteed	VDI 3441 Inspection guaranteed
Positioning	0.02mm / 300mm	±0.005mm / 300mm	P 0.014mm
Repeatability	±0.01mm	±0.003mm	PS 0.01mm

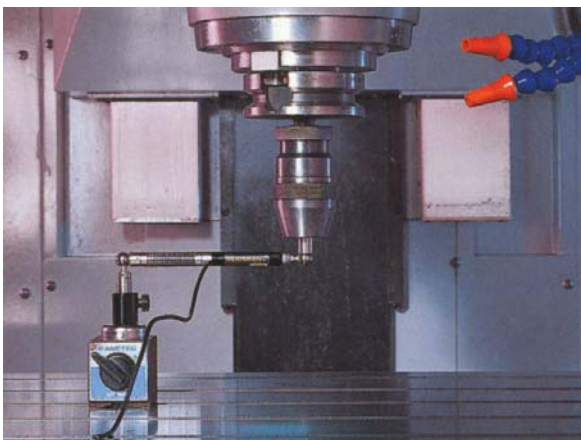

Ball bar test



Laser inspection

OPTIONAL ACCESSORIES



Tool length & radius measurement



Tool laser measurement



32 / 40 Tools arm type ATC



Workpiece probe



CNC Rotary table

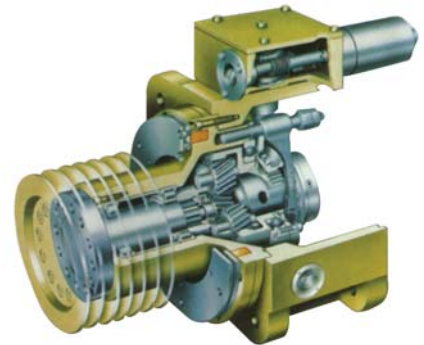

Planetary gearbox



Coolant thru spindle device



Axis linear glass scales



Chain type chip conveyor



▲ FANCU 0iM / 31iM



▲ SIEMENS
828D / 840D

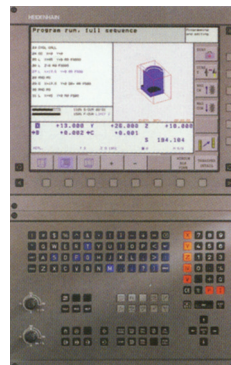

▲ HEIDENHAIN
iTNC 640

▼ PULL STUD & TOOL SHANK

TOOL SHANK(STD)
BT-50

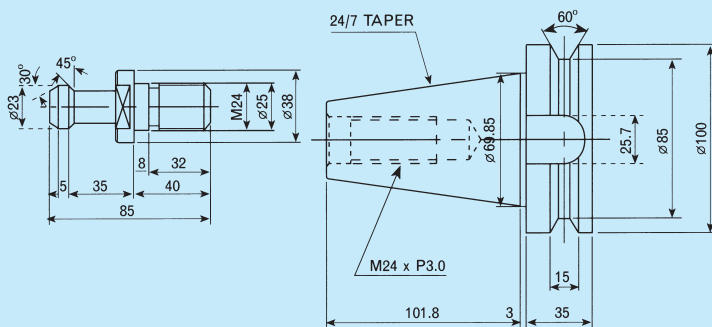

TOOL SHANK(STD)
CAT-50 / DIN69871

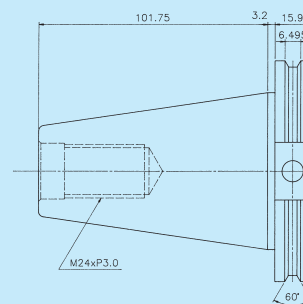

BT-40(STD)

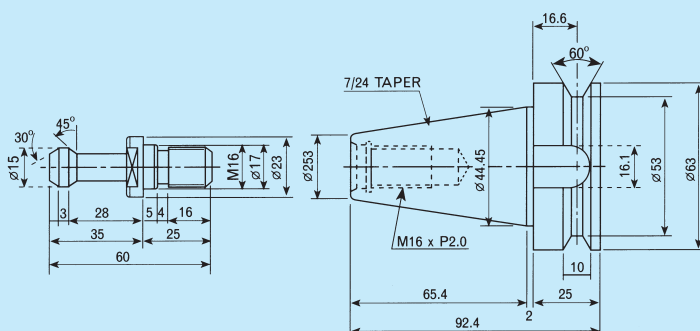

CAT-40 DIN 69871(STD)

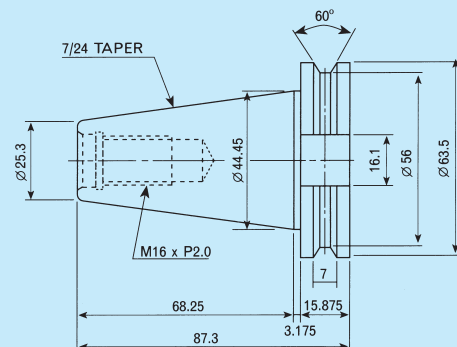

▼ DIMENSIONS unit: mm

VMC-2150

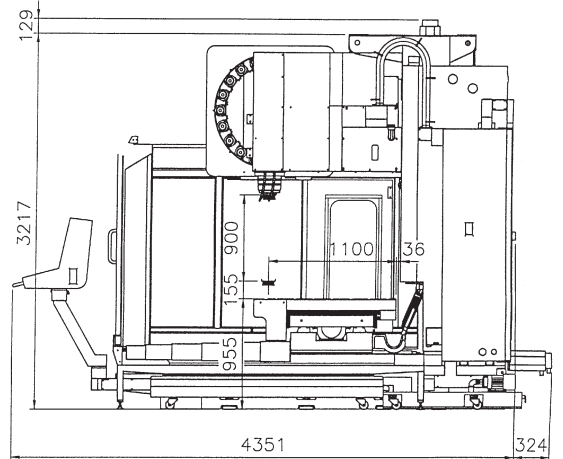
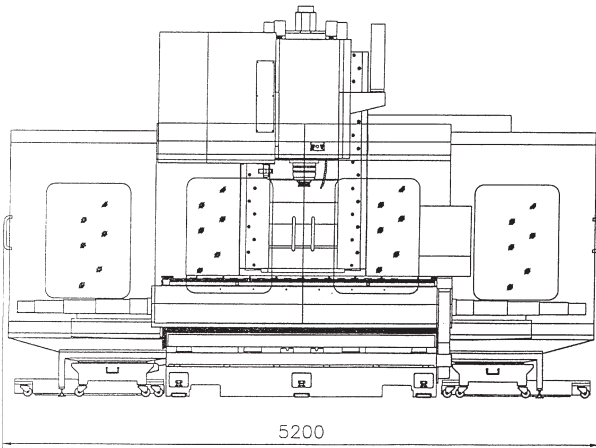

VMC-2600

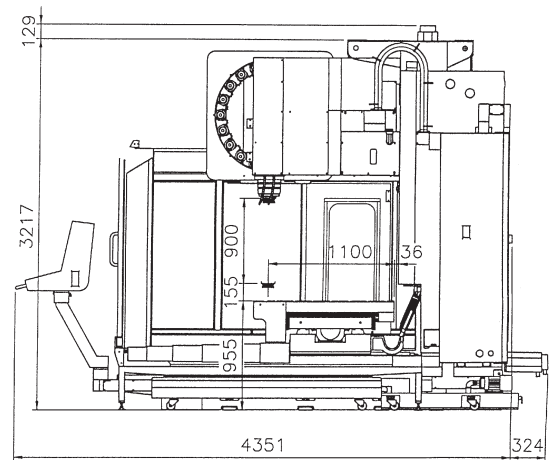
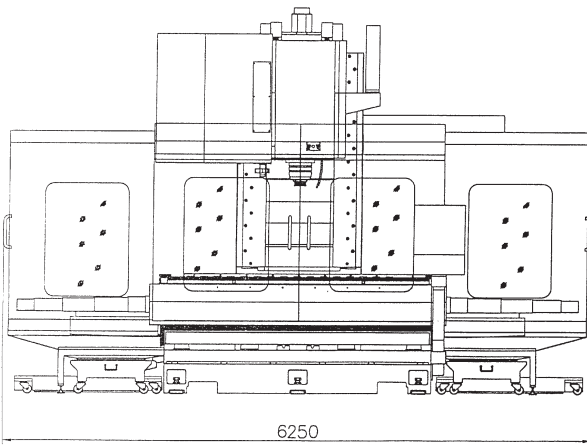

VMC-3200

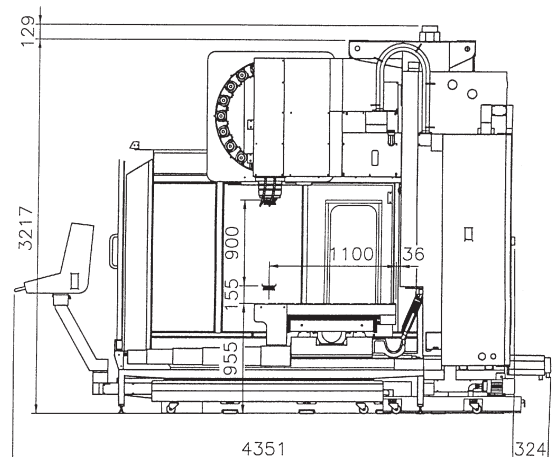
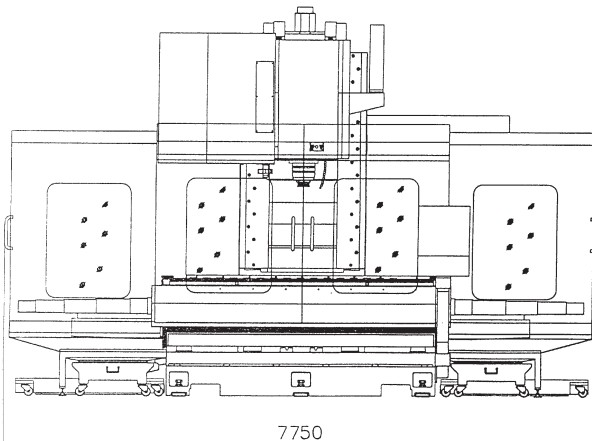

SPECIFICATIONS

Model	Description	VMC-2150	VMC-2600	VMC-3200
Table	Table size	2200 x 1220 mm	2650 x 1220 mm	3250 x 1220 mm
	T slots	22 mm x 7 x 160 mm		
	Max. table load	2500 kgs	3000 kgs	3500 kgs
	Travel ranges (X / Y / Z)	2150 / 1100 / 900 mm	2600 / 1100 / 900 mm	3200 / 1100 / 900 mm
	Spindle center to column	1136 mm		
	Spindle nose to table surface	151 - 1051 mm		
	Table to floor	875 mm		
Spindle	Tool shank and pull stud	50 BT / CAT (opt. 40 BT / CAT)		
	Spindle speed	6000 rpm (opt. 10000 rpm)		
	Spindle inner diameter	90 mm		
	Main motor	18.5 / 22 kw (22 / 26 kw)		
Axis Servo Motors X / Y / Z	Power	4.8 / 7.4 / 4.8 kw		
	Toque	30 / 40 / 30 Nm		
Feed Rate X / Y / Z	Cutting feed rate	1 - 8000 mm/min		
Rapid Feed Rate	X / Y / Z	15 / 15 / 15 M / min		
	Minimum setting	0.001 mm		
Automatic Tool Changer	MAG type	Arm type		
	Tool storage Capacity	24 Tools (opt. 32 / 40 Tools)		
	Max. tool (dia. / length)	250 / 300 mm		
	Max. tool weight	15 kgs		
	Tool to tool	10 Sec.		
	Chip to chip	18 Sec.		
Ballscrews on 3 Axes	Dia. x Pitch	63 / 63 / 63 mm x 10 mm		
	Precision class	C3, 0.008 mm / 300 mm		
Coolant and Lubrication	Coolant motor power	0.86 kw		
	Coolant tank capacity	350 L		
	Coolant motor capacity	20 L / min		
	Lubrication motor power	25 Watt x 2		
	Lubrication tank capacity	4 L		
Accuracy	Positioning	± 5 Micron / 300 mm		
	Repeatability	3 Micron		
	Roundness	10 Micron / Dia. 300 mm		
Miscellaneous	Machine net weight	21000 kgs	22000 kgs	24000 kgs
	Power requirement	35 KVA		
	Air Requirement	7 kg / cm ²		

※THE DESIGN & SPECIFICATIONS ARE SUBJECT TO CHANGE WITHOUT PRIOR NOTICE.

■ STANDARD ACCESSORIES:

- | | |
|--|---------------------------------|
| 1. 24-tools arm type ATC | 8. Remote MPG |
| 2. BT #50 spindle & ATC, belt driven headstock | 9. RS-232C |
| 3. Programmable coolant system | 10. Operation status light |
| 4. Automatic lubrication system | 11. Work light |
| 5. Spindle air blast system | 12. Tool box & tools |
| 6. Pre-extension ballscrews | 13. Leveling bolts & pads |
| 7. Screw chip conveyor rear side of saddle | 14. Operation & program manuals |

■ OPTIONS:

1. Coolant through spindle
2. Coolant through tool holder
3. 32-tools arm type ATC
4. 40-tools arm type ATC
5. BT40 spindle & ATC
6. Automatic tool length measurement

CNC-TAKANG CO., LTD.

No. 72, Alley 7, Lane 98, 1st Road, Taichung Industry Park,
Taichung 40767, TAIWAN
FAX: +886-4-2359 6064 E-mail: takang@ms17.hinet.net
TEL: (04)2359 6056 Web site: www.cnctakang.com.tw