

HEAVY DUTY CNC LATHES **SLANT BED**

Model: TNC35 Series
VR33 Series
VR38 Series
VR43 Series

SWING: 660 - 1100 mm (26" - 43")
B.C.: 860 - 7070 mm

Special Design for Heavy Cutting

CNC-TAKANG

CNC-TAKANG CO., LTD.
MANUFACTURER & EXPORTER

**HEAVY DUTY CNC LATHES
SLANT BED**

■ FEATURES:

One piece 45-degree slant bed design and heavy-duty construction with 40" Max. cutting diameter is a powerful machine tool used for turning and shaping metal parts. The 45-degree slant bed design provides stability and rigidity to the machine, which allows for precise and accurate cutting.

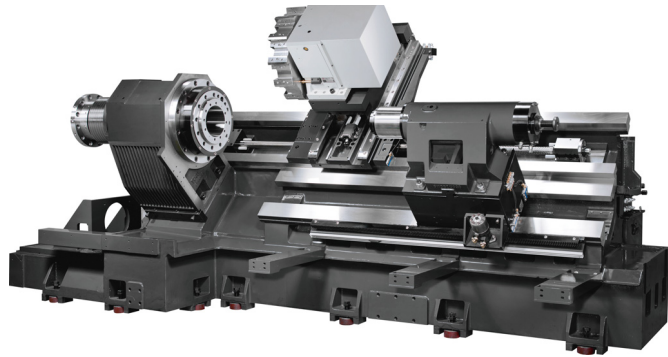
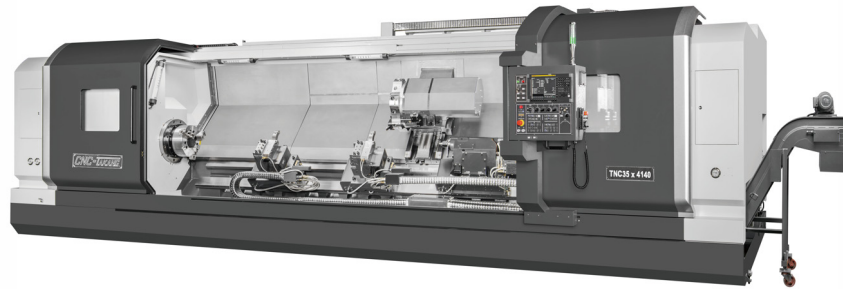

**SPECIAL SPINDLE GEAR SET
IN HEADSTOCK**

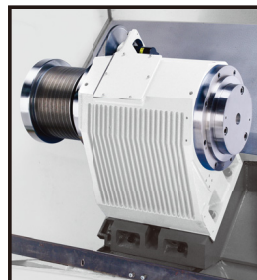

Head stock

2

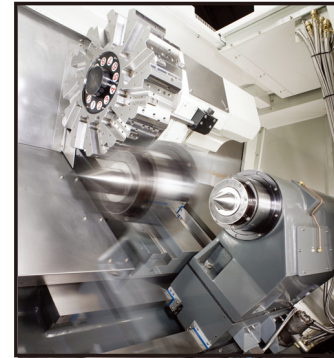

PROGRAMMABLE TAILSTOCK

The heavy-duty construction ensures that the tailstock can withstand the forces generated by heavy cutting operations and maintain stability throughout. Extra-long quill travel on the tailstock reduces interference range to the tool turret. This means that the tailstock can be moved further away from the turret, providing more space for the cutting tool to operate. This feature is particularly useful when working with large workpieces or when multiple tools are needed to complete a job.



Turret

Conical clutch for high-accuracy positioning, ensuring that the cutting tool is precisely aligned with the workpiece. Provides a secure and accurate grip on the tool, minimizing the risk of slippage or misalignment during operation. Taking only 1 second for the next tool position and 2.7 seconds for the opposite tool position. This ensures that the machine can operate with maximum efficiency, minimizing downtime and increasing productivity.



3

TNC35 / VR Series

■ TURRET INTERFERENCE Unit :mm (inch) (TNC35 / VR33 Series)

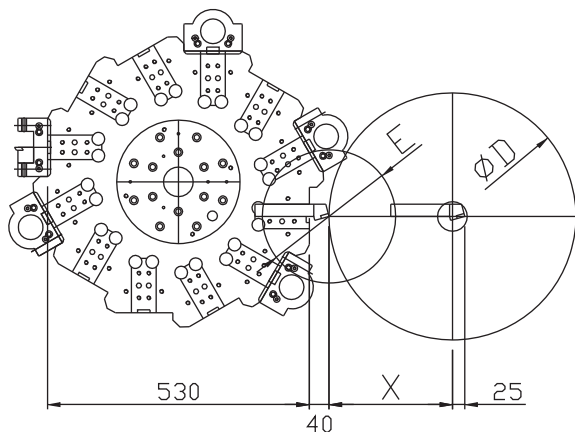

	D Turning Dia.	X	E (I.D. 40 mm)		E (I.D. 50 mm)	
			10T	12T	10T	12T
			TNC35	500	275	345
VR33	710	380	345	280	335	270

■ WORK RANGE Unit :mm (inch) (TNC35 / VR33 Series)

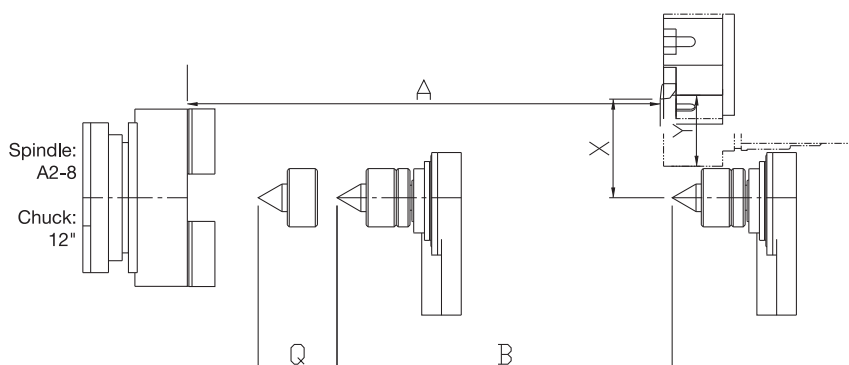

Spec.	A	B	X	Y	Q (Stable Quill + Live Center MT5)
TNC35 x 3140	3090	2930	275	180	100
TNC35 x 4140	4090	3930	275	180	100
TNC35 x 5140	5090	4930	275	180	100
TNC35 x 6140	6090	5930	275	180	100
VR33 x 860	810	650	380	290	100
VR33 x 1620	1570	1410	380	290	100
VR33 x 2380	2330	2170	380	290	100
VR33 x 3140	3090	2930	380	290	100
VR33 x 4140	4090	3930	380	290	100
VR33 x 5140	5090	4930	380	290	100
VR33 x 6140	6090	5930	380	290	100

TNC35 / VR Series

■ TURRET INTERFERENCE AND WORK RANGE Unit :mm (inch) (VR38 / 43 Series)

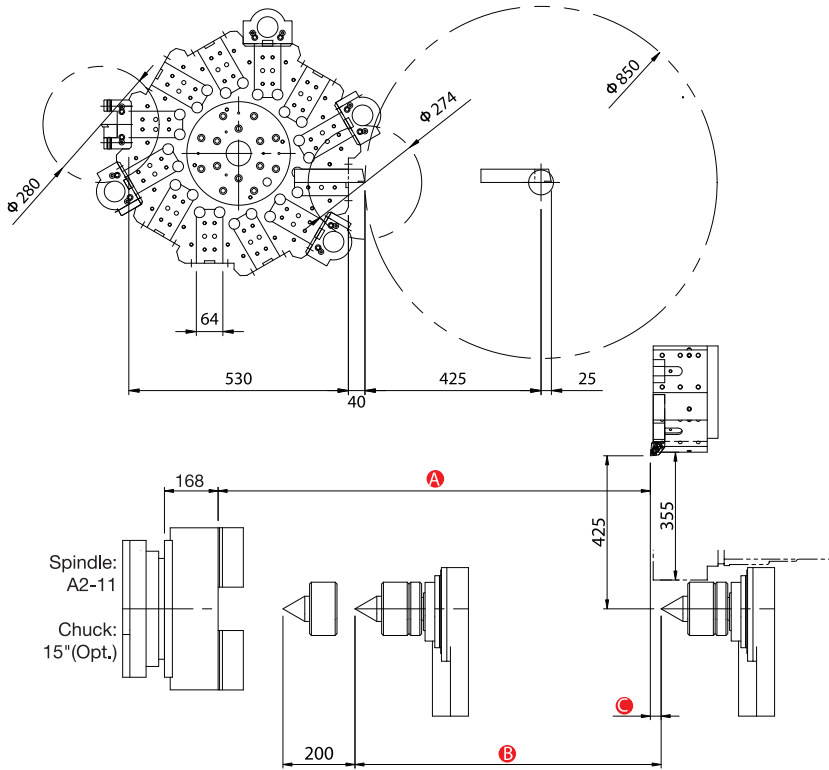

Spec.	A	B	C
VR38 x 1250	1196	950	206
VR38 x 1750	1696	1450	206
VR38 x 2250	2196	1950	206
VR38 x 3210	3156	2910	206
VR38 x 4150	4096	3850	206
VR38 x 5150	5096	4850	206
VR38 x 6150	6096	5850	206
VR38 x 7150	7096	6850	206
VR43 x 2260	2200	1900	30
VR43 x 3220	3200	2900	30
VR43 x 4200	4200	3900	30
VR43 x 5190	5200	4900	30
VR43 x 6070	6200	5900	30
VR43 x 7070	7200	6900	30

■ TURRET INTERFERENCE AND WORK RANGE Unit :mm (inch) (TNC35 Series with driving turret)

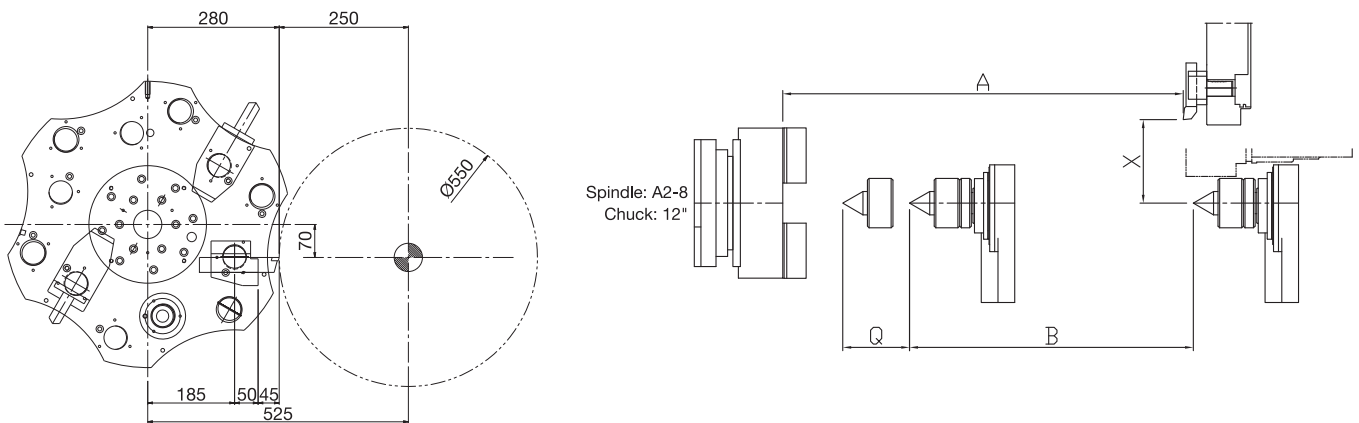

Spec.	A	B	X	Q (Stable Quill + Live Center MT5)	Max. turning dia.	Max. milling dia.
TNC35 x 3140	3086	2876	290	100	500	440
TNC35 x 4140	4086	3876	290	100	500	440
TNC35 x 5140	5086	4876	290	100	500	440
TNC35 x 6140	6086	5876	290	100	500	440

VR Series

■ TURRET INTERFERENCE AND WORK RANGE Unit :mm (inch)

(VR33 Series with driving turret)

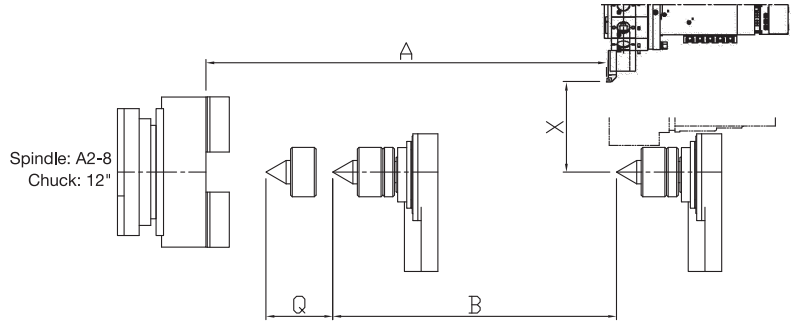
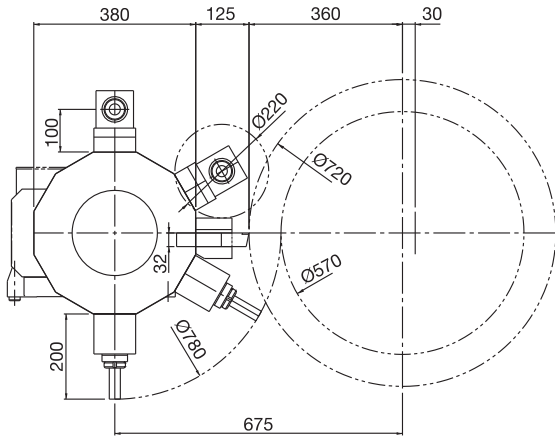

Spec.	A	B	X	Q (Stable Quill + Live Center MT5)	Max. turning dia.	Max. milling dia.
VR33 x 860	806	596	395	100	710	570
VR33 x 1620	1566	1358	395	100	710	570
VR33 x 2380	2326	2116	395	100	710	570
VR33 x 3140	3086	2876	395	100	710	570
VR33 x 4140	4086	3876	395	100	710	570
VR33 x 5140	5086	4876	395	100	710	570
VR33 x 6140	6086	5876	395	100	710	570

(VR38 Series with driving turret)

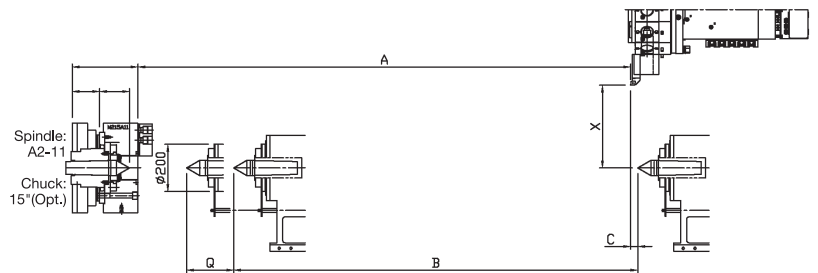
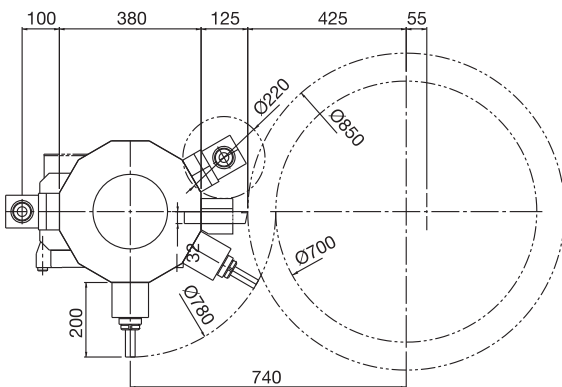

Spec.	A	B	X	Q (Rotating Quill + Dead Center MT5)	C	Max. turning dia.	Max. milling dia.
VR38 x 1250	1250	1060	470	200	100	850	700
VR38 x 1750	1750	1560	470	200	100	850	700
VR38 x 2250	2250	2060	470	200	100	850	700
VR38 x 3210	3210	3020	470	200	100	850	700
VR38 x 4150	4150	3960	470	200	100	850	700
VR38 x 5150	5150	4960	470	200	100	850	700
VR38 x 6150	6150	5960	470	200	100	850	700
VR38 x 7150	7150	6960	470	200	100	850	700

TNC35 / VR Series

■ TURRET INTERFERENCE AND WORK RANGE Unit :mm (inch) (VR43 Series with driving turret)

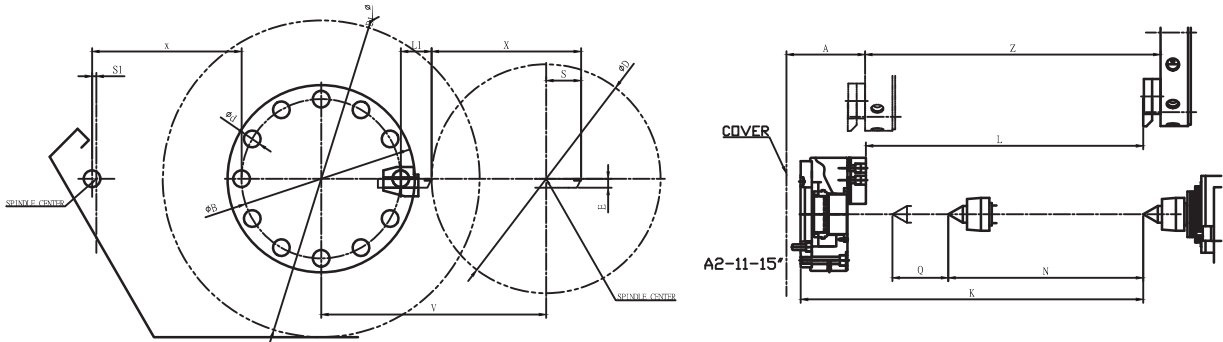

Model	A	D	D1	d	E	H	K	L	L1	N	Q	S	S1	V	X	Z	B
VR43 x 2260	281.5	820	1120	60	32	-	2428	2195	47.5	1900	200	47.5	15	805	535	2260	570
VR43 x 3220	281.5	820	1090	60	32	-	3418	3185	47.5	2900	200	47.5	15	805	535	3220	570
VR43 x 4200	281.5	820	1060	60	32	-	4353	4120	47.5	3900	200	47.5	15	805	535	4090	570
VR43 x 5190	281.5	820	1030	60	32	-	5335	5102	47.5	4900	200	47.5	15	805	535	5070	570
VR43 x 6070	281.5	820	1000	60	32	-	6335	6102	47.5	5900	200	47.5	15	805	535	6070	570
VR43 x 7070	281.5	820	970	60	32	-	7335	7102	47.5	6900	200	47.5	15	805	535	7070	570

■ DIMENSION Unit : mm (inch)

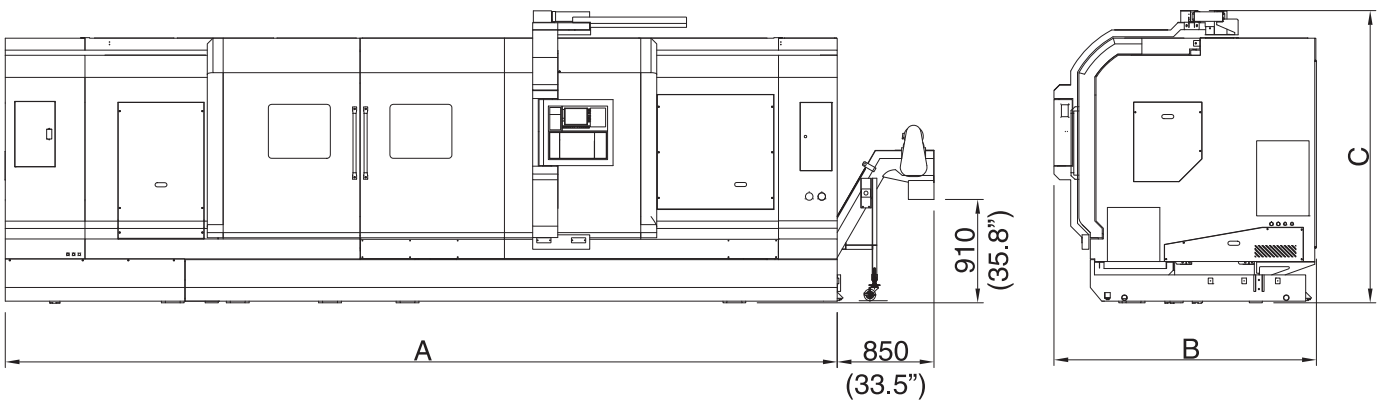

Model	Length: A	B	C
TNC35 x 3140	7584 (298.5")	2290 (90.1")	2565 (100.9")
TNC35 x 4140	8155 (321")		
TNC35 x 5140	9300 (366.1")		
TNC35 x 6140	10325 (406.4")		
VR33 x 860	5304 (208.8")	2130 (83.8")	2235 (88")
VR33 x 1620	6064 (238.7")		
VR33 x 2380	6824 (268.6")	2290 (90.1")	2565 (100.9")
VR33 x 3140	7584 (298.5")		
VR33 x 4140	8155 (321")		
VR33 x 5140	9300 (366.1")		
VR33 x 6140	10325 (406.4")		

Model	Length: A	B	C
VR38 x 1250	6160 (242.5")	2230 (87.8")	2445 (96.2")
VR38 x 1750	6660 (262.2")		
VR38 x 2250	7160 (281.8")		
VR38 x 3210	8160 (321")	2390 (94")	2775 (109.2")
VR38 x 4150	9160 (360.6")		
VR38 x 5150	10160 (400")		
VR38 x 6150	11160 (439.3")		
VR38 x 7150	12160 (478.7")	2540 (100")	2925 (115.1")
VR43 x 2260	8700 (342.5")	3158 (124.3")	3050 (120")
VR43 x 3220	9700 (381.8")		
VR43 x 4200	10700 (421.2")	3318 (130.6")	3380 (133")
VR43 x 5200	11700 (460.6")		
VR43 x 6070	12700 (500")		
VR43 x 7070	13700 (539.3")	3468 (136.5")	3530 (138.9")

TNC35 / VR Series

MAIN SPINDLE MOTOR OUTPUT AND TORQUE (TNC35 / VR33 Series)

Spindle: A2-8
 Spindle bore: $\varnothing 105\text{mm}$
 Spindle gearbox: 2-speed
 Spindle motor: $\alpha 22i$ (22/26kW)

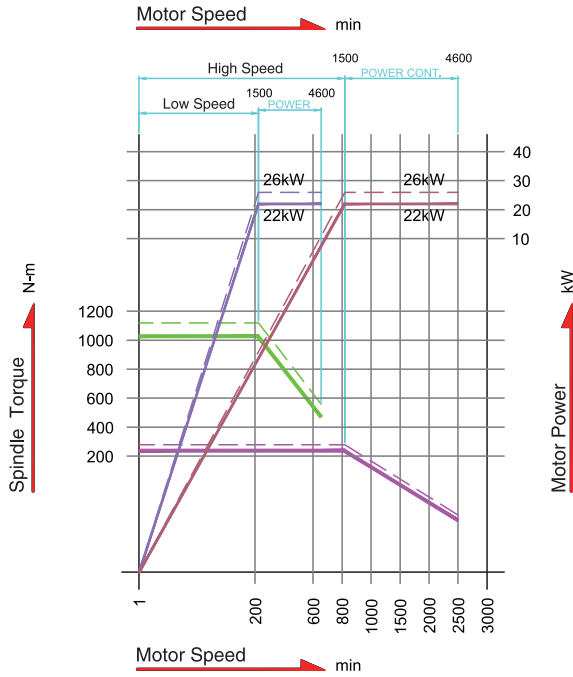

Spindle: A2-11
 Spindle bore: $\varnothing 131\text{mm}$
 Spindle gearbox: 2-speed
 Spindle motor: $\alpha 22i$ (22/26kW)

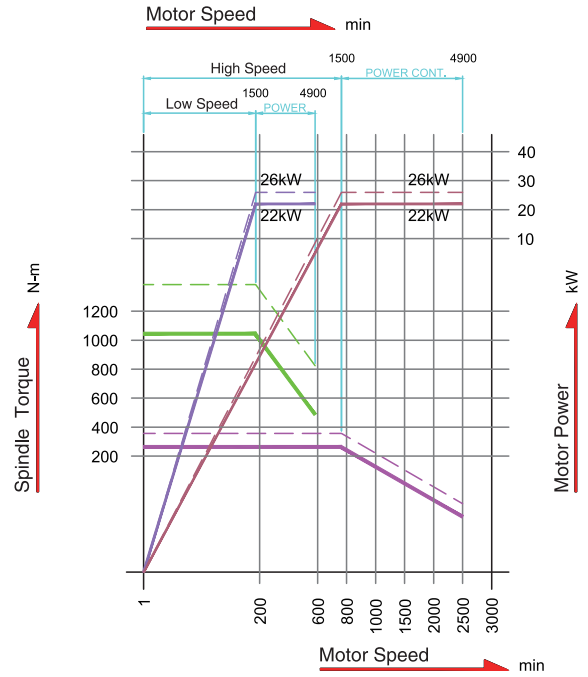

Spindle: A2-15
 Spindle bore: $\varnothing 180\text{mm}$
 Spindle gearbox: 2-speed
 Spindle motor: $\alpha 22i$ (22/26kW)

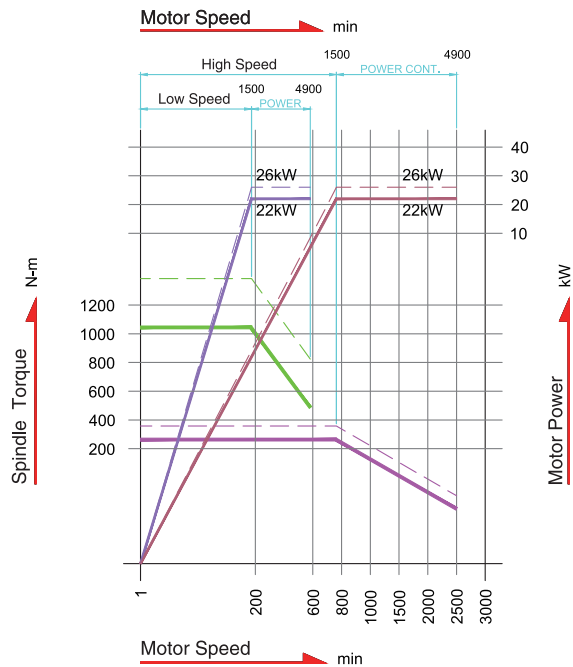

Spindle Torque	Motor Power	Low speed 30min. operation zone
High speed 30min. operation zone	Low speed continuous operation zone	High speed continuous operation zone

MAIN SPINDLE MOTOR OUTPUT AND TORQUE (VR38 Series)

Spindle: A2-11
 Spindle bore: $\varnothing 160\text{mm}$
 Spindle gear head: 3-speed
 Spindle motor: $\alpha 30i$ (30/37kW)

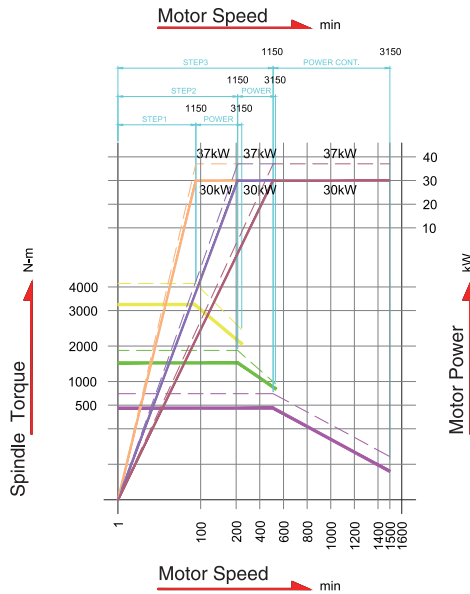

Spindle Torque Motor Power
 --- STEP1-30min, operation zone
 --- STEP2-30min, operation zone
 --- STEP3-30min, operation zone
 --- STEP1-Continuous
 --- STEP2-Continuous
 --- STEP3-Continuous

Spindle: A2-15
 Spindle bore: $\varnothing 230\text{mm}$
 Spindle gear head: 3-speed
 Spindle motor: $\alpha 30i$ (30/37kW)

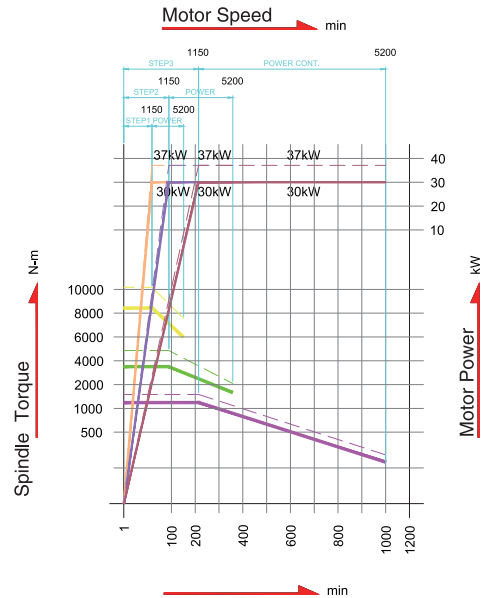

Spindle Torque Motor Power
 --- STEP1-30min, operation zone
 --- STEP2-30min, operation zone
 --- STEP3-30min, operation zone
 --- STEP1-Continuous
 --- STEP2-Continuous
 --- STEP3-Continuous

Spindle: A2-20
 Spindle bore: $\varnothing 320\text{mm}$
 Spindle gear head: 3-speed
 Spindle motor: $\alpha 30i$ (30/37kW)

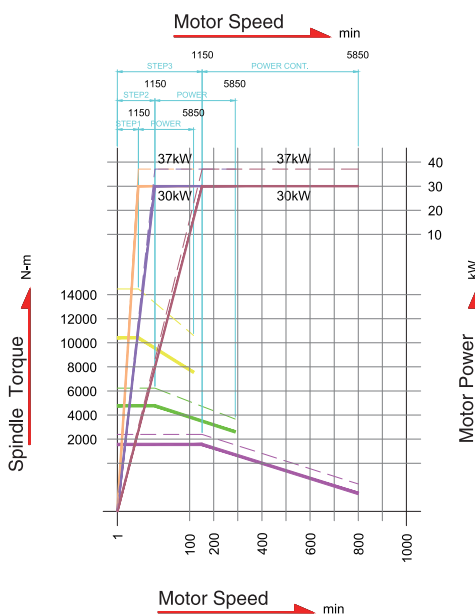

Spindle Torque Motor Power
 --- STEP1-30min, operation zone
 --- STEP2-30min, operation zone
 --- STEP3-30min, operation zone
 --- STEP1-Continuous
 --- STEP2-Continuous
 --- STEP3-Continuous

Spindle: A2-20
 Spindle bore: $\varnothing 360\text{mm}$
 Spindle gear head: 2-speed
 Spindle motor: $\alpha 30i$ (30/37kW)

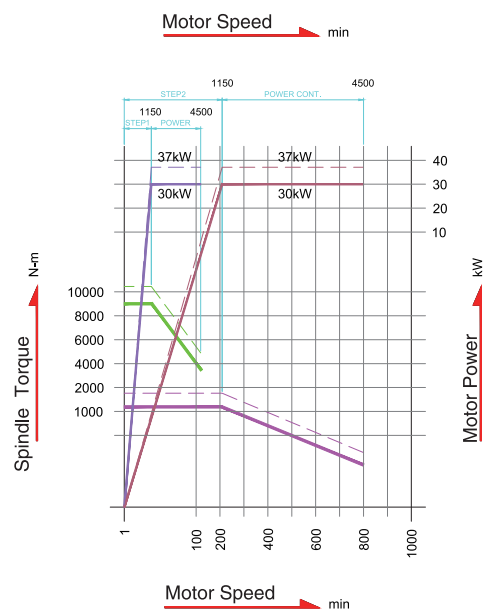

Spindle Torque Motor Power
 --- STEP1-30min, operation zone
 --- STEP2-30min, operation zone
 --- STEP1-Continuous
 --- STEP2-Continuous

VR Series

■ MAIN SPINDLE MOTOR OUTPUT AND TORQUE (VR43 Series)

Spindle: A2-11
 Spindle bore: $\varnothing 160\text{mm}$
 Spindle gear head: 4-speed
 Spindle motor: $\alpha 40i$ (37/45kW)

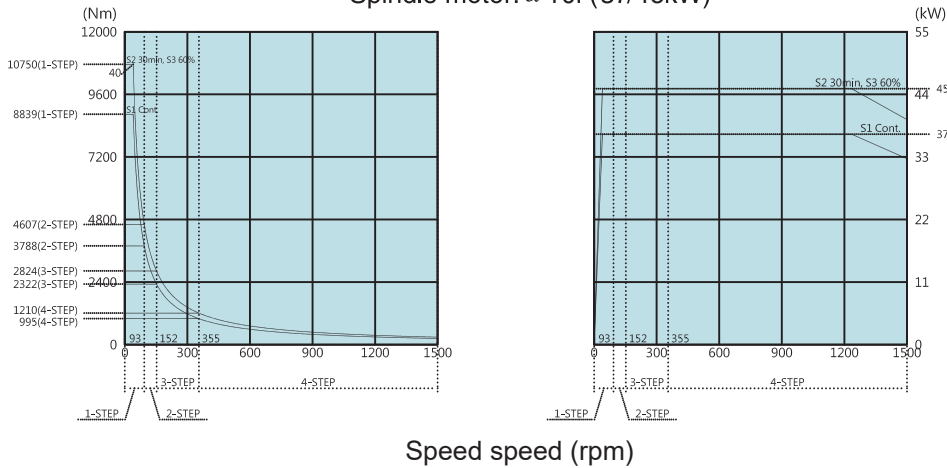

Speed speed (rpm)

Spindle: A2-15
 Spindle bore: $\varnothing 230\text{mm}$
 Spindle gear head: 4-speed
 Spindle motor: $\alpha 40i$ (37/45kW)

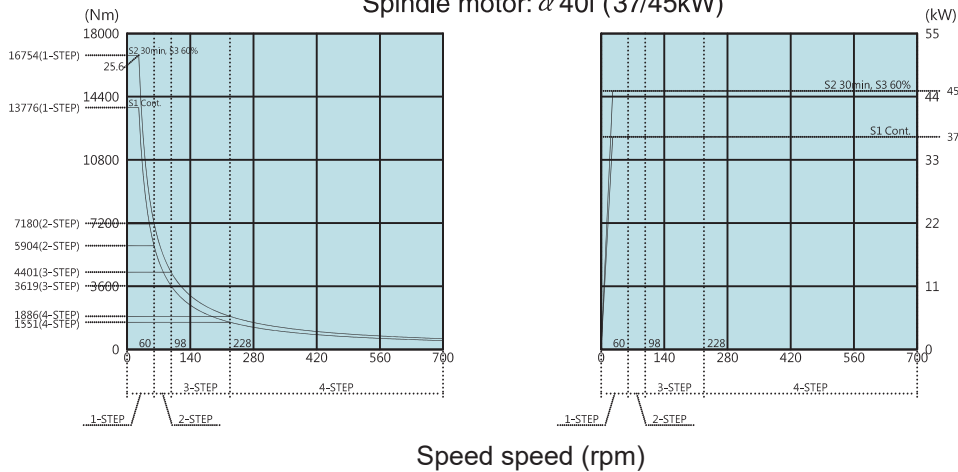

Speed speed (rpm)

Spindle: A2-20
 Spindle bore: $\varnothing 320\text{mm}$
 Spindle gear head: 4-speed
 Spindle motor: $\alpha 40i$ (37/45kW)

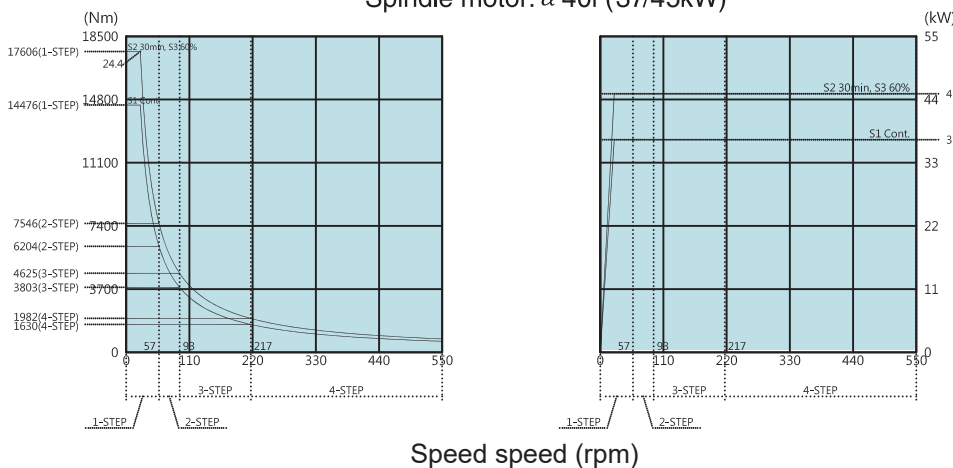

Speed speed (rpm)

SPECIFICATIONS

		TNC35 x 3140	TNC35 x 4140	TNC35 x 5140	TNC35 x 6140
Capacity	Swing over bed	660 mm (25.9")			
	Swing over cross slide	480 mm (18.9")			
	Max turning diameter	500 mm (19.6")			
	Working length	3040 mm (119.6")	4040 mm (159")	5040 mm (198.4")	6040 mm (237.79")
Spindle	Spindle nose	A2-8 / Opt. A2-11			
	Spindle bore	Dia. 105 mm (4.1") / Opt. 131 mm (5.1"), 165 mm (6.5")			
	Bar capacity	Dia. 89 mm (3.5") / Opt. 117 mm (4.6"), 142 mm (5.6")			
	Max. spindle speed	2500 rpm / Opt. 2000, 1650 rpm			
	Spindle gearbox step	2			
Chuck	Hydraulic chuck size	Std. 12" / Opt: 15"			
Turret	Turret type	V10 / Opt. V12			
	Tool size	32 mm (1.25") / Opt. 25 mm (1")			
	ID tool holder diameter	Dia. 50 mm (2")			
X/Z axis	X axis travel	250 + 25 mm (9.84+1")			
	Z axis travel	3140 mm (123.6")	4140 mm (163")	5140 mm (202.3")	6140 mm (241.73")
	X / Z axis rapid travel	X: 12 M / min Z: 12 M / min	X: 12 M / min Z: 8 M / min		
	X / Z axis ball screw	Dia. 40 mm x P6 / Dia. 63 mm x P10			
	Cutting feed rate	0.001 ~ 500 mm / min			
Motor	Spindle	22 / 26 Kw			
	X / Z axis servo motor	4 / 4 Kw			
	Hydraulic pump	2.2 Kw			
	Coolant pump	0.75 Kw			
Tailstock	Tailstock travel	2930 mm (115.3")	3930 mm (154.7")	4930 mm (194.1")	5930 mm (233.46")
	Quill stroke	100 mm (3.9")			
	Quill diameter	110 mm (4.3")			
	Taper of center	MT5			
Dimension	Machine dimension	7584 x 2290 x 2565 mm	8155 x 2290 x 2565 mm	9300 x 2290 x 2565 mm	10325 x 2290 x 2565 mm
	Machine weight	16300 kgs	17500 kgs	19000 kgs	21000 kgs

※THE SPECIFICATIONS ARE SUBJECT TO CHANGE WITHOUT PRIOR NOTICE.

■ STANDARD ACCESSORIES:

1. Fanuc control and motors
2. 12" 3-jaw hydraulic chuck
3. 10 stations servo turret
4. Auto coolant, hydraulic and lubrication system
5. Programmable tailstock with fixed quill
6. Splash guard
7. Work light
8. Chip conveyor
9. Tool box with tools

■ OPTIONS:

1. Extra spindle bore and motor
2. Spindle oil chiller
3. Extra chuck
4. Programmable tailstock with rotating quill
5. C axis with driving tool turret
6. Tool presetter (Auto / Manual)
7. CE mark
8. Transformer

VR33 Series

SPECIFICATIONS

		VR33 x 860	VR33 x 1620	VR33 x 2380	VR33 x 3140	VR33 x 4140	VR33 x 5140	VR33 x 6140
Capacity	Swing over bed	850 mm (33.4")						
	Swing over cross slide	640 mm (25.1")						
	Max turning diameter	710 mm (27.9")						
	Working length	760 mm (29.9")	1520 mm (59.8")	2280 mm (89.7")	3040 mm (119.6")	4040 mm (159")	5040 mm (198.4")	6040 mm (237.79")
Spindle	Spindle nose	A2-8		Opt. A2-11			Opt. A2-15	
	Spindle bore	Dia. 105 mm (4.1")		Opt. 131 mm (5.1"), 165 mm (6.5")			Opt. 180 mm (7")	
	Bar capacity	Dia. 89 mm (3.5")		Opt. 117 mm (4.6"), 142 mm (5.6")			Opt. 166 mm (6.5")	
	Max. spindle speed	2500 rpm		Opt. 2000 , 1650 rpm			Opt. 1300 rpm	
	Spindle gearbox step	2						
Chuck	Hydraulic chuck size	Std. 12" / Opt. 15" / 18"						
Turret	Turret type	V10 / Opt. V12						
	Tool size	32 mm (1.25") / Opt. 25 mm (1")						
	ID tool holder diameter	Dia. 50 mm (2")						
X / Z axis	X axis travel	355 + 25 mm (13.97+1")						
	Z axis travel	860 mm (33.8")	1620 mm (63.7")	2380 mm (93.7")	3140 mm (123.6")	4140 mm (163")	5140 mm (202.3")	6140 mm (241.73")
	X / Z axis rapid travel	X: 12 M / min Z: 15 M / min			X: 12 M / min Z: 10 M / min	X: 12 M / min Z: 8 M / min		
	X / Z axis ball screw	Dia. 40 mm x P6 / Dia. 50 mm x P10		Dia. 40 mm x P6 / Dia. 63 mm x P10				
	Cutting feed rate	0.001~500 mm / min						
Motor	Spindle	22 / 26 Kw						
	X / Z axis servo motor	4 / 4 Kw						
	Hydraulic pump	2.2 Kw						
	Coolant pump	0.75 Kw						
Tailstock	Tailstock travel	650 mm (25.5")	1410 mm (55.5")	2170 mm (85.4")	2930 mm (115.3")	3930 mm (154.7")	4930 mm (194.1")	5930 mm (233.46")
	Quill stroke	100 mm (3.9")						
	Quill diameter	110 mm (4.3")						
	Taper of center	MT5						
Dimension	Machine dimension	5304 x 2130 x 2235 mm	6064 x 2130 x 2235 mm	6824 x 2130 x 2235 mm	7584 x 2290 x 2565 mm	8155 x 2290 x 2565 mm	9300 x 2290 x 2565 mm	10325 x 2290 x 2565 mm
	Machine weight	11500 kgs	12100 kgs	15600 kgs	17900 kgs	19500 kgs	21200 kgs	23000 kgs

STANDARD ACCESSORIES:

1. Fanuc control and motors
2. 12" 3-jaw hydraulic chuck
3. 10 stations servo turret
4. Auto coolant, hydraulic and lubrication system
5. Programmable tailstock with fixed quill
6. Splash guard
7. Work light
8. Chip conveyor
9. Tool box with tools

OPTIONS:

1. Extra spindle bore and motor
2. Spindle oil chiller
3. Extra chuck
4. Programmable tailstock with rotating quill
5. C axis with driving tool turret
6. Y axis
7. Tool presetter (Auto / Manual)
8. CE mark
9. Transformer

※THE SPECIFICATIONS ARE SUBJECT TO CHANGE WITHOUT PRIOR NOTICE.

VR38 Series

SPECIFICATIONS

		VR38 x 1250	VR38 x 1750	VR38 x 2250	VR38 x 3210	VR38 x 4150	VR38 x 5150	VR38 x 6150	VR38 x 7150
Capacity	Swing over bed	970 mm (38.1")							
	Swing over cross slide	720 mm (28.3")							
	Max turning diameter	850 mm (33.4")							
	Working length	1130 mm (44.4")	1630 mm (64.1")	2130 mm (83.8")	3090 mm (121.6")	4030 mm (158.6")	5030 mm (198")	6030 mm (237.4")	7030 mm (276.77")
Spindle	Spindle nose	A2-11			Opt. A2-15		Opt. A2-20		
	Spindle bore	Dia. 160 mm (6.3")			Opt. dia. 230 mm (9")		Opt. dia. 320 mm (13"), 360 mm (14.1")		
	Bar capacity	Opt. dia. 142 mm (5.6")			Opt. 205 mm (8")		Deped on chuck		
	Max. spindle speed	1500 rpm			Opt. 700 rpm		Opt. 550 , 450 rpm		
	Spindle gearbox step	3							
Turret	Turret type	V12							
	Tool size	32 mm (1.25")							
	ID tool holder diameter	Dia. 50 mm (2")							
X / Z axis	X axis travel	425 + 25 mm (16.7" + 1")							
	Z axis travel	1250 mm (49.2")	1750 mm (68.8")	2250 mm (88.5")	3210 mm (126.3")	4150 mm (163.3")	5150 mm (202.7")	6150 mm (242.13")	7150 mm (281.5")
	X / Z axis rapid travel	X: 12 M / min Z: 15 M / min			X: 12 M / min Z: 10 M / min		X: 12 M / min Z: 8 M / min		
	X / Z axis ball screw	Dia. 40 mm x P6 / Dia. 50 mm x P10			Dia. 40 mm x P6 / Dia. 63 mm x P10				
	Cutting feed rate	0.001 ~ 500 mm / min							
Motor	Spindle	30 / 37 Kw							
	X / Z axis servo motor	4 / 7 Kw							
	Hydraulic pump	3.75 Kw							
	Coolant pump	0.75 Kw							
Tailstock	Tailstock travel	950 mm (37.4")	1450 mm (57")	1950 mm (76.7")	2910 mm (114.5")	3850 mm (151.5")	4850 mm (190.9")	5850 mm (230.31")	6850 mm (269.69")
	Quill stroke	160 mm (6.3")							
	Quill diameter	160 mm (6.3") - Rotating quill							
	Taper of center	MT6							
Dimension	Machine dimension	6160 x 2230 x 2445 mm	6660 x 2230 x 2445 mm	7160 x 2230 x 2445 mm	8160 x 2390 x 2775 mm	9160 x 2390 x 2775 mm	10160 x 2390 x 2775 mm	11160 x 2465 x 2850 mm	12160 x 2540 x 2925 mm
	Machine weight	14200 kgs	14950 kgs	15700 kgs	18400 kgs	20100 kgs	21900 kgs	23700 kgs	25500 kgs

※THE SPECIFICATIONS ARE SUBJECT TO CHANGE WITHOUT PRIOR NOTICE.

■ STANDARD ACCESSORIES:

1. Fanuc control and motors
2. 6" spindle bore
3. 12 stations servo turret
4. Auto coolant, hydraulic and lubrication system
5. Programmable hydraulic tailstock with rotating quill
6. Splash guard
7. Work light
8. Chip conveyor
9. Tool box with tools

■ OPTIONS:

1. Extra spindle bore and motor
2. Spindle oil chiller
3. Chuck or rear chuck adapter
4. C axis with driving tool turret
5. Y axis
6. Tool presetter (Auto / Manual)
7. CE mark
8. Transformer

SPECIFICATIONS

		VR43 x 2260	VR43 x 3220	VR43 x 4200	VR43 x 5190	VR43 x 6070	VR43 x 7070
Capacity	Swing over bed	1100 mm (43")					
	Swing over cross slide	940 mm (37")					
	Max turning diameter	1020 mm (40")					
	Working length	2150 mm (84.7")	3140 mm (123.6")	4075 mm (160.4")	5055 mm (199")	6055 mm (238.4")	7055 mm (277.76")
Spindle	Spindle nose	A2-11	Opt. A2-15	Opt. A2-20			
	Spindle bore	Dia. 160 mm (6.3")	Opt. dia. 230 mm (9")	Opt. dia. 320 mm (13"), 360 mm (14.1")			
	Max. spindle speed	1500 rpm	Opt. 700 rpm	Opt. 550 , 450 rpm			
	Bar capacity	dia. 142 mm (5.6")	Opt. 205 mm (8")	Deped on chuck			
	Spindle gearbox step	4					
Turret	Turret type	V12					
	Tool size	32 mm (1.25")					
	ID tool holder diameter	Dia. 50 mm (2")					
X/Z axis	X axis travel	510 + 25 (20"+1")					
	Z axis travel	2260 mm (88.9")	3220 mm (126.7")	4090 mm (161")	5070 mm (199.6")	6070 mm (238.9")	7070 mm (278.3")
	X / Z axis rapid travel	X: 12 M / min Z: 15 M / min	X: 12 M / min Z: 10 M / min	X: 12 M / min Z: 8 M / min			
	X / Z axis ball screw	Dia. 40 mm x P6 / Dia. 63 mm x P10					
	Cutting feed rate	0.001 ~ 500 mm / min					
Motor	Spindle	37 / 45 Kw					
	X / Z axis servo motor	4 / 7 Kw					
	Hydraulic pump	3.75 Kw					
	Coolant pump	0.75 Kw					
Tailstock	Tailstock travel	1900 mm (74.8")	2900 mm (114.1")	3900 mm (153.5")	4900 mm (192.9")	5900 mm (232.2")	6900 mm (271.65")
	Quill stroke	200 mm (7.87")					
	Quill diameter	200 mm (7.87")- Rotating quill					
	Taper of center	MT6					
Dimension	Machine dimension	8700 x 3158 x 3050 mm	9700 x 3318 x 3380 mm	10700 x 3318 x 3380 mm	11700 x 3318 x 3380 mm	12700 x 3393 x 3455 mm	13700 x 3468 x 3530 mm
	Machine weight	18000 kgs	23000 kgs	27000 kgs	32000 kgs	37000 kgs	42000 kgs

※THE SPECIFICATIONS ARE SUBJECT TO CHANGE WITHOUT PRIOR NOTICE.

■ STANDARD ACCESSORIES:

Same as VR38 Series (P.8)

■ OPTIONS:

Same as VR38 Series (P.8)

CNC-TAKANG CO., LTD.

No. 72, Alley 7, Lane 98, 1st Road, Taichung Industry Park,
Taichung 40767, TAIWAN
FAX: +886-4-2359 6064 E-mail: takang@ms17.hinet.net
TEL: (04)2359 6056 Web site: www.cnctakang.com